

34924	03/06 → Wand-Einhandmischer DN 15	single lever wall mixer DN 15	ééngreeps wandmengkraan 1/2"
	74 366 Kartusche, KLUDI MEDI-CARE	cartridge, KLUDI MEDI-CARE	cartouche, KLUDI MEDI-CARE
	75 179 Rosette	wall flange	rozet
	75 335 Wandarmaturanschluss	wall-fitting connection	wandmengkraan aansluiting
	76 018 Care-Strahlregler	Care flow straightener	Care-mondstuk
	76 551 S-Anschluss mit Schalldämpfer	S-connection with sound absorber	S-koppeling met geluiddemper
	76 938 Dichtungssatz	sealing set	set dichtingen
	76 939 Gussauslauf KLUDI MEDI-CARE	casted spout KLUDI MEDI-CARE	gegoten uitloop KLUDI MEDI-CARE
	76 940 Desinfektionskranz	disinfecting rim	desinfectiering
	76 943 KLUDI MEDI-CARE, Klinik-Armhebel	KLUDI MEDI-CARE, arm lever for hospital purpose	KLUDI MEDI-CARE, lange hendel
	76 944 Spannhülse	fastening cap	spanhuls
	922 020 Auslaufbefestigungsschraube	fastening screw for spout	bev. schroef voor uitloop
	922 225 Nirosta-Schraube	Stainless screw	Nirosta schroef

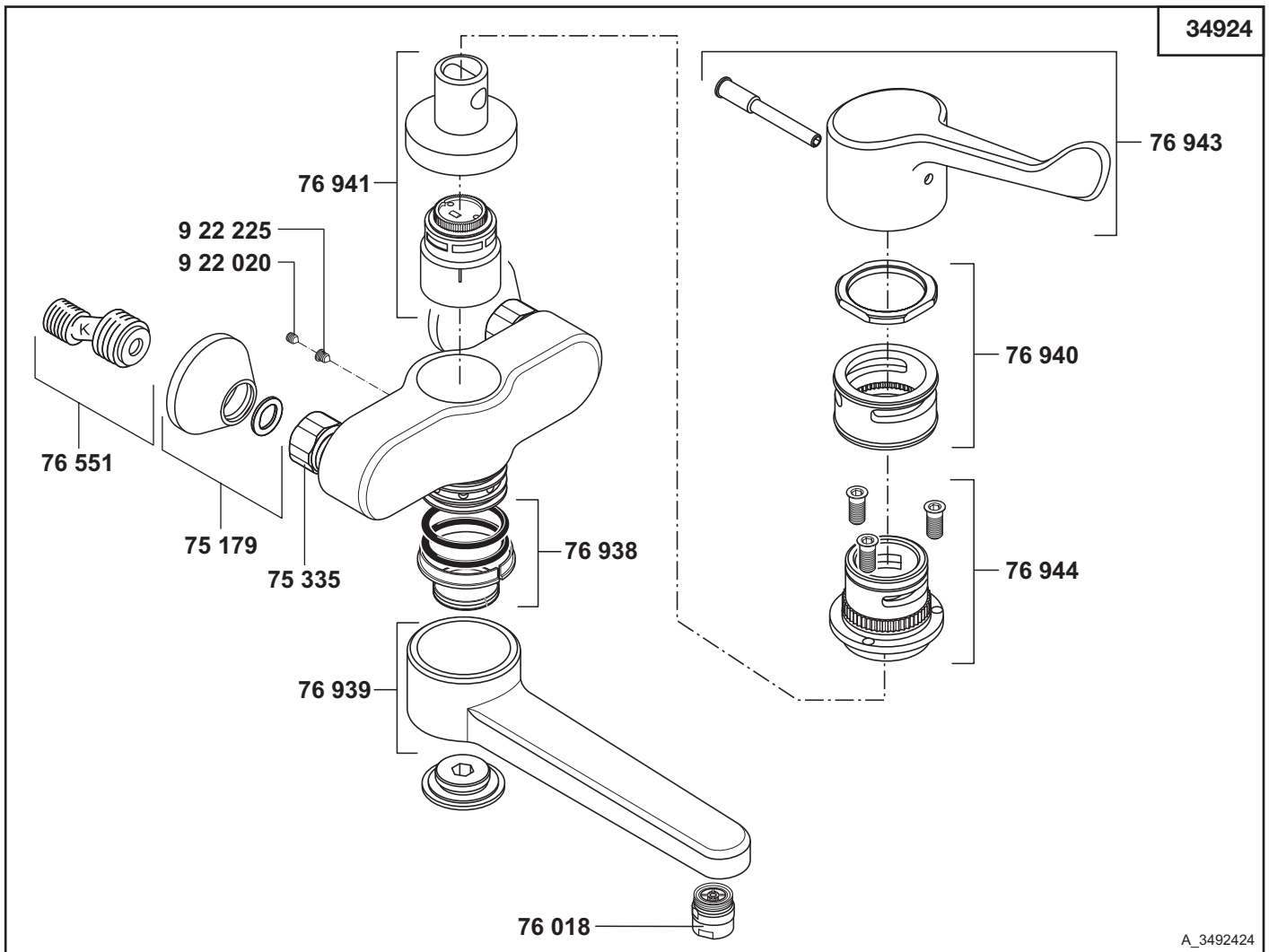

A\_3492424

34924	Wand-Einhandmischer DN 15	single lever wall mixer DN 15	ééngreeps wandmengkraan 1/2"
	75 179 Rosette 75 335 Wandarmaturanschluss 76 018 Care-Strahlregler 76 551 S-Anschluss mit Schalldämpfer 76 938 Dichtungssatz 76 939 Gussauslauf KLUDI MEDI-CARE 76 940 Desinfektionskranz 76 941 Kartusche, KLUDI MEDI-CARE 76 943 KLUDI MEDI-CARE, Klinik-Armhebel  76 944 Spannhülse 922 020 Auslaufbefestigungsschraube 922 225 Nirosta-Schraube	wall flange wall-fitting connection care flow straightener S-connection with sound absorber sealing set casted spout KLUDI MEDI-CARE disinfecting rim cartridge, KLUDI MEDI-CARE KLUDI MEDI-CARE, arm lever for hospital purpose fastening cap fastening screw for spout Stainless screw	rozet wandmengkraan aansluiting Care-mondstuk S-koppeling met geluiddemper set dichtingen gegoten uitloop KLUDI MEDI-CARE desinfectiering cartouche, KLUDI MEDI-CARE KLUDI MEDI-CARE, lange hendel  spanhuls bev. schroef voor uitloop Nirosta schroef